

Sai Siri Opel

2 & 3 BHK luxury flats suiting your life
@ Rajarajeshwarinagar, Bengaluru.



Project by :



Sai Siri Promoters

Sai Siri Opel



The revolutionery growth in technology has set a rapid development of the Garden city, with IT Corridor, International Airport, Multi-specility Hospitals, Amazing Multiplexes, Metro Train and many others, enhancing the glory of Bengaluru. The spur in IT has set the style of living and expectations of the people to global standards.

Here is the sincere effort of "Sai Siri Opel" to provide the IT Professionals and business magnates etc.,

The real value for their living, beyond expectations!

Highlights

- Ideal Residential Location - to suit your mood
- Close to park & Temples - serenity at hands reach
- Financial prospects - no hassles foreseen
- Generator for common areas, lift & two points for each flat - Stay powered
- Vastu achieved interior layout - Sentiment respected
- Both Corporation and Borewell - Uninterrupted
- Just 10 minutes drive from Arch.
- Just away from Krishna Global Village.



Specifications

Structure

- RCC framed structure with ISI standard TMT steel and cement solid block masonry walls.
- 6" cement solid block for exterior walls and 4" cement solid blocks for interior walls.

Flooring

- Good quality 2'X2' vitrified tile flooring and skirting in living, dining, bedrooms and kitchen.
- Good quality anti skid ceramic tile flooring in bathroom.
- Good quality granite treads & risers for staircase.
- Sadaralli grey granite flooring and skirting in lobby and common areas.

Kitchen

- Black granite (30 mm) platform with stainless steel sink.
- Ceramic wall tiling upto 2' level above the platform.
- Provision for water purifier.

Bathrooms

- Good quality ceramic wall tiling upto 7'.
- Asian paints premium emulsion paint for walls above 7' & ceiling.
- Hindware or equivalent sanitary ware. Jaguar CP bath fittings along with concealed plumbing.

Windows

- Red sal wood frames & teak wood shutters.

Doors

- Main door of teak wood frames and shutters.
- Bedroom doors of teak wood frames with teak wood laminated flush shutters.
- Balcony, bathroom & utility doors of red sal wood frame with waterproof flush shutter NIKI/KUTTI make or equivalent and matching hardware for the above.



Electrical

- Concealed conduiting with PVC insulated copper wires, anchor or equivalent.
- Modular switches.
- Television, telephone points in living & master bedroom.
- AC point in master bedroom.
- 2 lighting points with generator backup.

Water supply & sanitary system

- Water supply with underground sump and overhead tank with borewell water & Corporation water.
- 4" supreme make PVC sanitary lines.
- Rain water harvesting.

Painting

- Asian paints premium emulsion paint for interior walls and ceiling.
- Asian paints ACE paint for exterior walls.

Lift

- One 6 passenger automatic lift of johnson make.

Generator

- DG backup with sufficient capacity for lift, common area lighting & utilities.

Area Statements

FLOORS	SALEABLE AREAS IN S.F.T.				
Ground Floor	001 1230	002 1460	003 1455	004 1085	005 1210
First Floor	101 1395	102 1460	103 1455	104 1085	105 1395
Second Floor	201 1395	202 1460	203 1455	204 1085	205 1395
Third Floor	301 1395	302 1460	303 1455	304 1085	305 1395

Sai Siri Opel



Ground floor plan



Typical floor plan



LOCATION

Map



Sai Siri
Opel



Car Parking Floor Plan

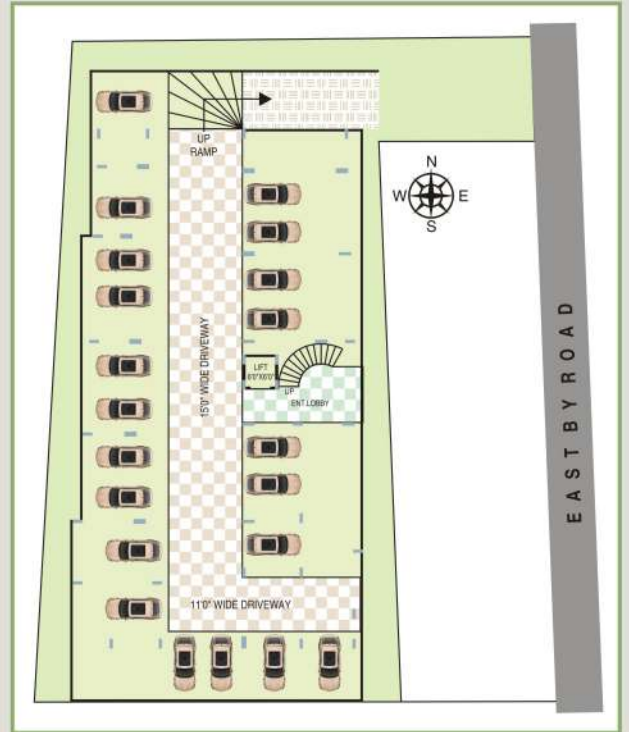

Commitment of Sai Siri's

Every square inch of project is finished to perfection be it the materials used or the fittings and accessories, you can be rest assured of, nothing but the best to last long and give you all the time to enjoy comfortable living.

CONSULTANTS:

YUKTI

ARCHITECTURE.ENGINEERING.INTERIORS

82, 1st FLOOR, 21st MAIN,
B.S.K. II STAGE, BANGALORE-560070.
PH:080 26713029 M:98458 11887
email:yuktiv@gmail.com.



Project by :

Sai Siri Promoters

No. 8, Ravi Hill View Layout, Ittumadu,
BSK 3rd Stage, Bengaluru - 560 085.

For details contact

Mr. Jaswan Chowdary
Mobile : 99004 29090

This brochure is purely conceptual. It is by no means a legal document.

The promoters, developers and the architects reserve the right to add, delete or alter any specifications, elevation or areas mentioned herein. If required.